

NOTES:

1. FOR HS-1 AND HS-5, SEE ADA RAMP CORNER TREATMENT DETAIL PER DOWNTOWN DESIGN DETAILS
2. FOR HS-4, SEE ALLEYWAY / DRIVEWAY LAYOUT DETAIL PER DOWNTOWN DESIGN DETAILS
3. SEE CROSSWALK DETAIL PER DOWNTOWN DESIGN DETAILS FOR DECORATIVE CROSSWALK MARKING PATTERN

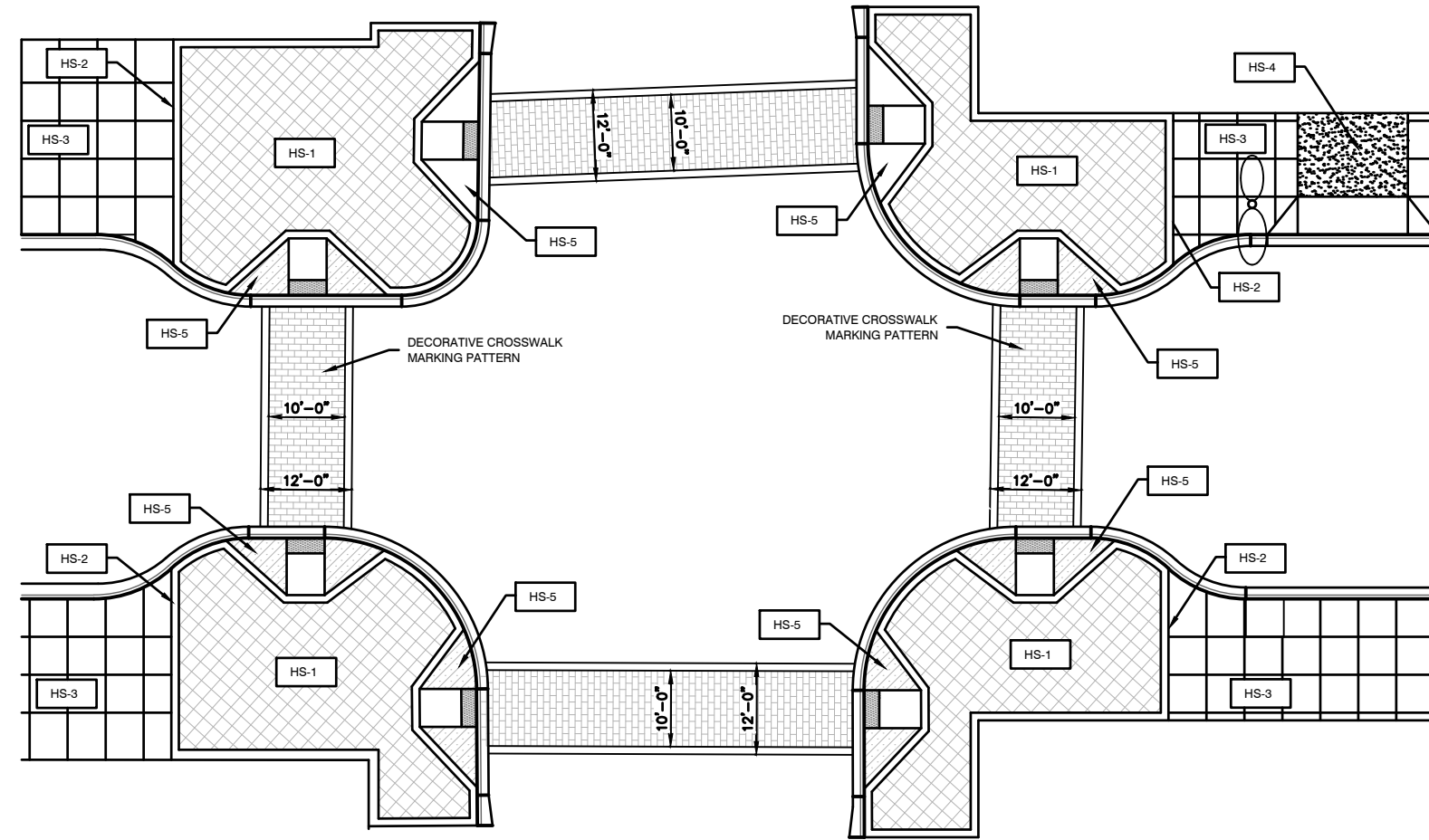

HARDSCAPE LEGEND

	HS-1	ACCENT PAVERS	CORNER ACCENT PAVERS: CITY STONE PAVERS COLOR: MISSION RED. MANUFACTURER: PAVESTONE OR APPROVED EQUAL. PAVERS TO BE INSTALLED AT A 45° DEGREES TO ADJACENT HARDSCAPE EDGE. PAVERS TO BE SURROUNDED BY 12" CONCRETE BAND. SEE REFERENCE HS-2 BELOW
	HS-2	CONCRETE BAND	12" WIDE BY 7-3/8" CONCRETE BAND. MEDIUM BROOM FINISH/SMOOTH TROWEL FINISH. COLOR: SOMBRERO BUFF (C-25) CHROMIX ADMIXTURE BY SCOFIELD OR APPROVED EQUAL.
	HS-3	MAIN WALK	GRAY CONCRETE. PICTURE FRAME FINISH WITH BROOM FINISH INTERIOR AND 4" SMOOTH FINISH BANDS. 5'X5' SCORING PATTERN. CLARK COUNTY USD DETAIL #234.
	HS-4	NEW DRIVEWAY / ALLEYWAY	INTEGRAL COLOR CONCRETE: DARK GRAY COLORED CONCRETE "SMOKE" BY DAVIS COLOR "COBBLESTONE" OR APPROVED EQUAL. COLORED CONCRETE SURFACE TO HAVE SMOOTH FINISH, TO BE SCORED PER PLANS, AND HAVE CONTINUOUS AND EQUAL LOOK IN COLOR AND TEXTURE. INSTALL PER MANUFACTURER'S SPECIFICATIONS AND RECOMMENDATIONS.
	HS-5	ADA RAMP CORNER	INTEGRAL COLOR CONCRETE RAMP COLOR: CLAY (RED) BY SALOMON OR APPROVED EQUAL.

